

PARISO HYDRAULIC MINERAL

HYDRAULIC COATING THERMAL INSULATION SYSTEM



APPLICATION



Spray..



..or Gravity Hopper



APPLICATION PROCEDURE



1 Fix starter profiles (base rail) in place.



2 Apply the MAITE adhesive in dabs or full notched trowel backing coat to the insulation and bond to the substrate.



3 Place insulation panels vertically to leave a smooth surface and check the line and level.



4 If specified, anchor the panels after hardening of adhesive dabs, then apply 1st coat of MAITE base layer coating.



5 Embed the AVU mesh into the MAITE, apply a further top coat of MAITE, leaving a scratch coat effect. Ensure that the mesh joints overlap by a min. of 100 mm.



6 Spray 1st coat of mineral coating EHI. Thickness 3/5 mm.



7 Trowel the first application of EHI and embed the TV10 mesh. Ensure the mesh joints overlap by a min. of 100 mm.



8 Apply 2nd layer of EHI (in one coat for scraped and 2 coats for spray textured). Total thickness of MAITE and EHI 12/15 mm.

PAREX

The information provided in this document results from our knowledge of the products and our experience. On-site results may vary, in particular according to the product application methods adopted. Where application methods not covered by this document are used, customers must request specific additional information and/or carry out a representative test before using the products. The above-mentioned information in no way constitutes a warranty relative to the use of the products. Our general terms and conditions of sale shall prevail, in any event, on the information provided in this document. Prior to application, customers and users are requested to check that they have the latest version of this document.

SYSTEMS COMPONENTS

Product and its function	Product	Consumption	Packaging
1 MAITE MONOCOMPOSANT Mortar for sticking the insulation	MAITE MONOCOMPOSANT	2.6 to 3.5 kg/m ² powder	Pallet of 40 x 30 kg bags
2 Expanding anchors to fix insulation (only when required)	FXE 40.60 FXE 70.80	Minimum 6 per panel	Box of 200 fittings
3 Insulating panel in expanded polystyrene, 1200 x 600 thickness 40 to 120 mm	Consult Parex on special grades & requirements		
4 MAITE MONOCOMPOSANT mortar basecoat can be colour matched	MAITE MONOCOMPOSANT	1.10 m ² /m ² minimum for standard sections	Roll 50 m x 1 m
5 AVU mesh embedded into MAITE MONOCOMPOSANT (4)	AVU Mesh	1.10 m ² /m ² minimum for standard sections	Roll 50 m x 1 m
6 Hydraulic coating on Insulation for decoration and protection of system. Possible finishes: scraped, spray textured, smooth textured	EHI	14 to 18 kg/m ² according to finish	Pallet of 40 x 30 kg bags
7 TV10 Mesh embedded into EHI (6)	TV10	1.10 m ² / m ² minimum for standard sections	Roll 50 m x 1 m

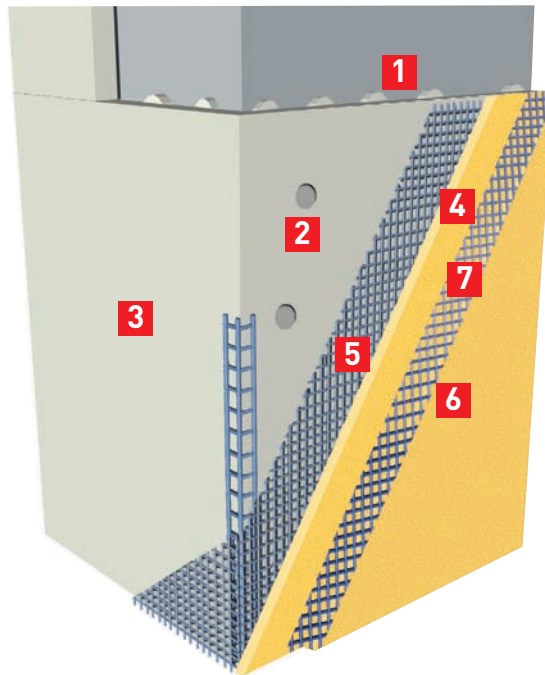

ACCESSORIES

Product and its function	Product	Quantity	Packaging
Insulation starter profiles (base rail) galvanised steel – length 2.5 m	BF WE65N	In accordance with worksite	3 m length
Stop profile - length 2.5 m	SP WE86N	In accordance with worksite	2.5 m length
Corner profile	MCB10W	In accordance with worksite	3 m length
Expandable hammer fixing anchors to fix starter and other profiles	FXC 6/5	2 to 3 fixing anchors per metre	Box of 200 fixings
Mastic for joints	603 LANKOFLEX	In accordance with worksite	Box of 12 cartridges

ATTENTION:

- Quantity is minimum amount where applicable.



European Organisation
of Technical Approvals.